

Retail / Restaurant for Lease

916 N Cable Road, Lima, OH

Free Standing Building for Lease

Former Rally's Restaurant

Year Built: 1989
Building Size: 706 SF
36' x 13' and 43' x 11'
Lot Size: 0.680 Acres
29,621 SF
Asking Rent: \$2,500/per month
NNN
Loopnet ID: 16411619

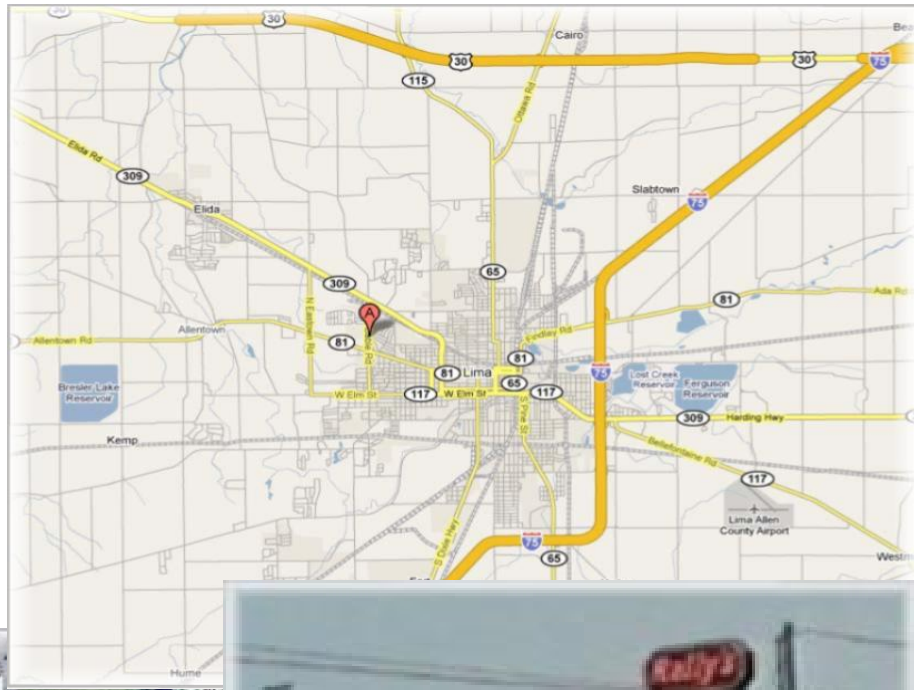

Demographics for 5 Mile Radius

Total Daytime Population: 76,844

Average Household Income: \$55,872

Median Age: 35

ADT: 9,950



Florida Equities, LLC
Licensed Real Estate Broker, Brian W. Smith

6300 NE 1st Ave, Suite 300, Fort Lauderdale, FL 33334
800-339-3234 bws@triplenetcorner.com
www.TripleNetCorner.com



N Cable Rd

N Cable Rd

25 feet

10 m

CABLE ROAD

CABLE

CITY OF LIMA CORPORATION LIMIT

LIMA CORPORATION LIMIT

ANDOVER COURT APARTMENTS

MACKENZIE

MACKENZIE DRIVE

3
1.55Ac

4
1.08Ac

4.001

5

6

7

(24705)

(24706)

183

373.12

80.4

832.4

1.5

149.8

77.7

373.3

372.9

60

373.5

35

372.3

60

373.9

140.91

120.3

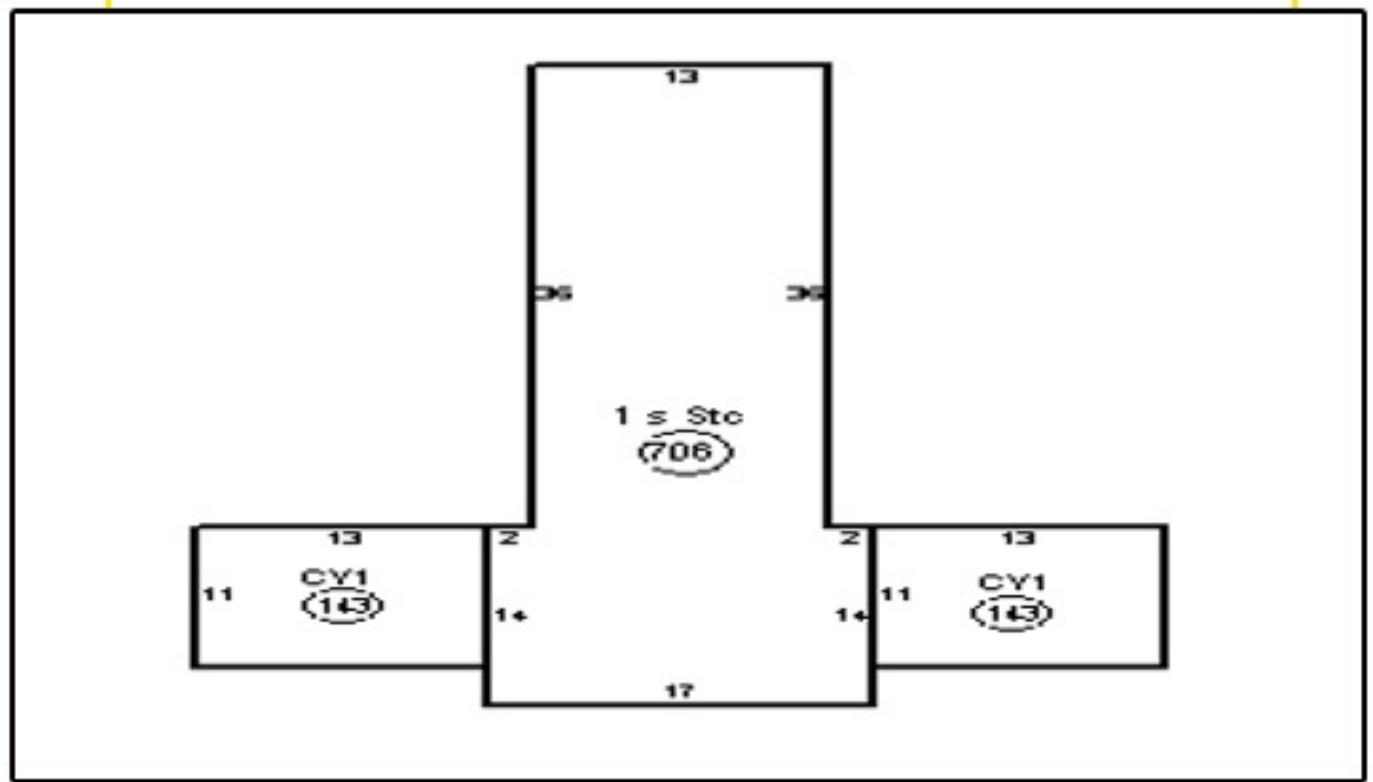

Population	1-mi.	3-mi.	5-mi.
2009 Male Population	2,923	21,767	34,734
2009 Female Population	3,080	22,261	34,965
% 2009 Male Population	48.69%	49.44%	49.83%
% 2009 Female Population	51.31%	50.56%	50.17%
2009 Total Adult Population	5,020	33,142	52,465
2009 Total Daytime Population	7,697	45,800	76,844
2009 Total Daytime Work Population	4,101	23,900	39,715
2009 Median Age Total Population	41	34	35
2009 Median Age Adult Population	48	43	44
2009 Age 0-5	335	3,796	5,769
2009 Age 6-13	404	4,659	7,563
2009 Age 14-17	243	2,431	3,902
2009 Age 18-20	634	2,334	3,389
2009 Age 21-24	313	2,645	3,921
2009 Age 25-29	368	3,309	4,862
2009 Age 30-34	263	2,815	4,338
2009 Age 35-39	299	2,801	4,577
2009 Age 40-44	345	3,203	5,234
2009 Age 45-49	340	2,997	5,137
2009 Age 50-54	425	2,836	4,763
2009 Age 55-59	305	2,220	3,761
2009 Age 60-64	267	1,733	2,969
2009 Age 65-69	263	1,517	2,428
2009 Age 70-74	350	1,533	2,322
2009 Age 75-79	325	1,349	2,085
2009 Age 80-84	254	981	1,437
2009 Age 85+	270	870	1,243
% 2009 Age 0-5	5.58%	8.62%	8.28%
% 2009 Age 6-13	6.73%	10.58%	10.85%
% 2009 Age 14-17	4.05%	5.52%	5.60%
% 2009 Age 18-20	10.56%	5.30%	4.86%
% 2009 Age 21-24	5.21%	6.01%	5.63%
% 2009 Age 25-29	6.13%	7.52%	6.98%
% 2009 Age 30-34	4.38%	6.39%	6.22%
% 2009 Age 35-39	4.98%	6.36%	6.57%
% 2009 Age 40-44	5.75%	7.27%	7.51%
% 2009 Age 45-49	5.66%	6.81%	7.37%
% 2009 Age 50-54	7.08%	6.44%	6.83%
% 2009 Age 55-59	5.08%	5.04%	5.40%
% 2009 Age 60-64	4.45%	3.94%	4.26%
% 2009 Age 65-69	4.38%	3.45%	3.48%
% 2009 Age 70-74	5.83%	3.48%	3.33%
% 2009 Age 75-79	5.41%	3.06%	2.99%
% 2009 Age 80-84	4.23%	2.23%	2.06%
% 2009 Age 85+	4.50%	1.98%	1.78%

2009 White Population	5,149	34,177	54,497
2009 Black Population	639	7,643	12,033
2009 Asian/Hawaiian/Pacific Islander	45	425	681
2009 American Indian/Alaska Native	4	151	200
2009 Other Population (Incl 2+ Races)	165	1,631	2,287
2009 Hispanic Population	88	949	1,433
2009 Non-Hispanic Population	5,914	43,080	68,265
% 2009 White Population	85.79%	77.63%	78.19%
% 2009 Black Population	10.65%	17.36%	17.26%
% 2009 Asian/Hawaiian/Pacific Islander	0.75%	0.97%	0.98%
% 2009 American Indian/Alaska Native	0.07%	0.34%	0.29%
% 2009 Other Population (Incl 2+ Races)	2.75%	3.70%	3.28%
% 2009 Hispanic Population	1.47%	2.16%	2.06%
% 2009 Non-Hispanic Population	98.53%	97.84%	97.94%
2000 Non-Hispanic White	5,720	36,171	56,932
2000 Non-Hispanic Black	550	8,080	12,755
2000 Non-Hispanic Amer Indian/Alaska Native	11	86	111
2000 Non-Hispanic Asian	10	311	449
2000 Non-Hispanic Hawaiian/Pacific Islander	n/a	9	9
2000 Non-Hispanic Some Other Race	2	93	102
2000 Non-Hispanic Two or More Races	53	1,065	1,518
% 2000 Non-Hispanic White	90.14%	78.95%	79.21%
% 2000 Non-Hispanic Black	8.67%	17.64%	17.75%
% 2000 Non-Hispanic Amer Indian/Alaska Native	0.17%	0.19%	0.15%
% 2000 Non-Hispanic Asian	0.16%	0.68%	0.62%
% 2000 Non-Hispanic Hawaiian/Pacific Islander	0.00%	0.02%	0.01%
% 2000 Non-Hispanic Some Other Race	0.03%	0.20%	0.14%
% 2000 Non-Hispanic Two or More Races	0.84%	2.32%	2.11%

Population Change	1-mi.	3-mi.	5-mi.
Total Employees	n/a	n/a	n/a
Total Establishments	n/a	n/a	n/a
2009 Total Population	6,003	44,028	69,698
2009 Total Households	2,729	18,283	28,182
Population Change 1990-2009	-594	-3,333	-6,164
Household Change 1990-2009	83	110	651
% Population Change 1990-2009	-9.00%	-7.04%	-8.13%
% Household Change 1990-2009	3.14%	0.61%	2.36%
Population Change 2000-2009	-497	-2,736	-3,434
Household Change 2000-2009	-7	27	406
% Population Change 2000-2009	-7.65%	-5.85%	-4.70%
% Households Change 2000-2009	-0.26%	0.15%	1.46%

Housing	1-mi.	3-mi.	5-mi.
2000 Total Housing Units	2,901	20,305	30,695
2000 Occupied Housing Units	2,737	18,206	27,733
2000 Owner Occupied Housing Units	2,009	11,084	18,456
2000 Renter Occupied Housing Units	727	7,122	9,277
2000 Vacant Housing Units	165	2,099	2,962
% 2000 Occupied Housing Units	94.35%	89.66%	90.35%
% 2000 Owner Occupied Housing Units	69.25%	54.59%	60.13%
% 2000 Renter Occupied Housing Units	25.06%	35.08%	30.22%
% 2000 Vacant Housing Units	5.69%	10.34%	9.65%

Income	1-mi.	3-mi.	5-mi.
2009 Median Household Income	\$37,473	\$36,608	\$38,230
2009 Per Capita Income	\$23,237	\$21,918	\$22,592
2009 Average Household Income	\$51,114	\$52,781	\$55,872
2009 Household Income < \$10,000	154	1,640	2,482
2009 Household Income \$10,000-\$14,999	236	1,423	2,111
2009 Household Income \$15,000-\$19,999	220	1,356	1,936
2009 Household Income \$20,000-\$24,999	282	1,497	2,156
2009 Household Income \$25,000-\$29,999	197	1,384	2,067
2009 Household Income \$30,000-\$34,999	181	1,397	2,083
2009 Household Income \$35,000-\$39,999	189	1,381	1,942
2009 Household Income \$40,000-\$44,999	261	1,536	2,198
2009 Household Income \$45,000-\$49,999	188	1,331	1,945
2009 Household Income \$50,000-\$59,999	353	2,051	3,380
2009 Household Income \$60,000-\$74,999	274	1,571	2,959
2009 Household Income \$75,000-\$99,999	86	958	1,664
2009 Household Income \$100,000-\$124,999	50	410	715
2009 Household Income \$125,000-\$149,999	37	189	315
2009 Household Income \$150,000-\$199,999	10	68	87
2009 Household Income \$200,000-\$249,999	3	25	41
2009 Household Income \$250,000-\$499,999	6	65	98
2009 Household Income \$500,000+	n/a	1	1
2009 Household Income \$200,000+	9	91	140
% 2009 Household Income < \$10,000	5.65%	8.97%	8.81%
% 2009 Household Income \$10,000-\$14,999	8.65%	7.78%	7.49%
% 2009 Household Income \$15,000-\$19,999	8.07%	7.42%	6.87%
% 2009 Household Income \$20,000-\$24,999	10.34%	8.19%	7.65%
% 2009 Household Income \$25,000-\$29,999	7.22%	7.57%	7.33%
% 2009 Household Income \$30,000-\$34,999	6.64%	7.64%	7.39%
% 2009 Household Income \$35,000-\$39,999	6.93%	7.55%	6.89%
% 2009 Household Income \$40,000-\$44,999	9.57%	8.40%	7.80%
% 2009 Household Income \$45,000-\$49,999	6.89%	7.28%	6.90%
% 2009 Household Income \$50,000-\$59,999	12.94%	11.22%	11.99%
% 2009 Household Income \$60,000-\$74,999	10.05%	8.59%	10.50%
% 2009 Household Income \$75,000-\$99,999	3.15%	5.24%	5.90%
% 2009 Household Income \$100,000-\$124,999	1.83%	2.24%	2.54%
% 2009 Household Income \$125,000-\$149,999	1.36%	1.03%	1.12%
% 2009 Household Income \$150,000-\$199,999	0.37%	0.37%	0.31%
% 2009 Household Income \$200,000-\$249,999	0.11%	0.14%	0.15%
% 2009 Household Income \$250,000-\$499,999	0.22%	0.36%	0.35%
% 2009 Household Income \$500,000+	0.00%	0.01%	0.00%
% 2009 Household Income \$200,000+	0.33%	0.50%	0.50%

Retail Sales Volume	1-mi.	3-mi.	5-mi.
2009 Children/Infants Clothing Stores	\$838,493	\$5,835,500	\$9,351,060
2009 Jewelry Stores	\$624,381	\$4,363,801	\$7,003,021
2009 Mens Clothing Stores	\$1,365,114	\$9,358,000	\$14,839,887
2009 Shoe Stores	\$1,254,000	\$8,577,409	\$13,596,019
2009 Womens Clothing Stores	\$2,616,876	\$17,675,708	\$27,756,577
2009 Automobile Dealers	\$16,053,145	\$110,249,668	\$174,044,717
2009 Automotive Parts/Acc/Repair Stores	\$1,991,525	\$13,685,769	\$21,677,106
2009 Other Motor Vehicle Dealers	\$609,348	\$4,181,361	\$6,629,681
2009 Tire Dealers	\$520,722	\$3,602,549	\$5,735,423
2009 Hardware Stores	\$201,466	\$1,447,923	\$2,336,657
2009 Home Centers	\$1,844,954	\$12,364,894	\$19,141,877
2009 Nursery/Garden Centers	\$525,671	\$3,666,788	\$5,858,142
2009 Outdoor Power Equipment Stores	\$203,099	\$1,382,454	\$2,142,200
2009 Paint/Wallpaper Stores	\$71,672	\$480,402	\$741,660
2009 Appliance/TV/Other Electronics Stores	\$1,513,542	\$10,431,291	\$16,628,990
2009 Camera/Photographic Supplies Stores	\$256,908	\$1,757,786	\$2,775,457
2009 Computer/Software Stores	\$826,930	\$5,595,357	\$8,770,518
2009 Beer/Wine/Liquor Stores	\$923,959	\$6,405,060	\$10,234,008
2009 Convenience/Specialty Food Stores	\$1,532,556	\$12,863,266	\$20,058,567
2009 Restaurant Expenditures	\$6,932,703	\$53,312,876	\$86,401,503
2009 Supermarkets/Other Grocery excl Conv	\$11,271,717	\$76,984,252	\$121,389,414
2009 Furniture Stores	\$1,583,248	\$10,862,607	\$17,199,988
2009 Home Furnishings Stores	\$961,193	\$6,669,356	\$10,662,752
2009 Gen Merch/Appliance/Furniture Stores	\$14,253,872	\$97,589,617	\$154,363,967
2009 Gasoline Stations w/ Convenience Stores	\$9,115,347	\$64,348,135	\$101,127,772
2009 Other Gasoline Stations	\$7,582,794	\$51,484,873	\$81,069,209
2009 Department Stores excl Leased Depts	\$15,767,416	\$108,020,910	\$170,992,960
2009 General Merchandise Stores	\$12,670,623	\$86,727,012	\$137,163,981
2009 Other Health/Personal Care Stores	\$1,060,031	\$7,250,916	\$11,407,775
2009 Pharmacies/Drug Stores	\$5,455,432	\$37,251,871	\$58,688,542
2009 Pet/Pet Supplies Stores	\$828,612	\$5,592,102	\$8,756,207
2009 Book/Periodical/Music Stores	\$391,144	\$2,541,545	\$3,921,341
2009 Hobby/Toy/Game Stores	\$397,292	\$2,590,249	\$3,840,888
2009 Musical Instrument/Supplies Stores	\$142,650	\$980,306	\$1,552,091
2009 Sewing/Needlework/Piece Goods Stores	\$60,498	\$401,294	\$623,455
2009 Sporting Goods Stores	\$660,709	\$4,808,420	\$8,059,903
2009 Video Tape Stores - Retail	\$126,914	\$871,884	\$1,382,721